

FOR SALE

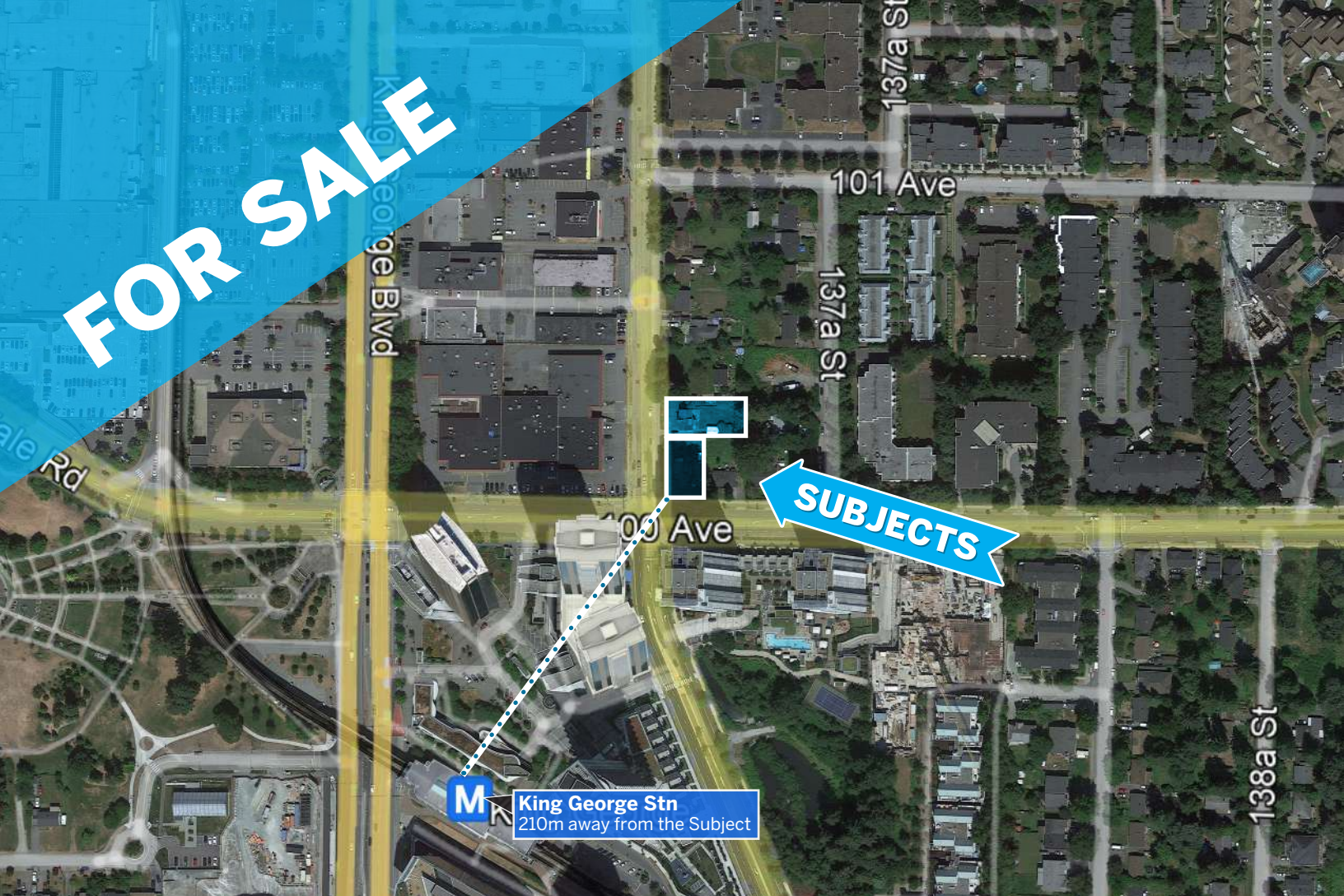

STRATEGIC HIGH-RISE DEVELOPMENT SITE

AREA:
SURREY CITY CENTRE

ADDRESS:
10024 Whalley Blvd. + 13691 100 Ave.,
Surrey, BC

SIZE:
0.44 Acres (19,166 Sq.ft.)

PRICE:
\$6,750,000

**HOMELIFE ADVANTAGE REALTY
(CENTRAL VALLEY) LTD.**

Joe Varing - Personal Real Estate Corporation Ltd.
604.565.3478 | info@varinggroup.com

360-3033 Immel Street, Abbotsford, BC V2S 6S2

This document has been prepared by Varing Marketing Group for marketing and general information only. Varing Marketing Group believes the information contained in this information package is correct, but makes no representations or warranties with respect thereto. Interested parties should complete their own independent investigations and enquiries as to the ownership and condition of the property and its suitability for any particular purpose. Not intended to cause breach of existing agency agreement.

VARINGTM
HOMELIFE ADVANTAGE REALTY
(CENTRAL VALLEY) LTD.

PROPERTY DESCRIPTION

CIVIC ADDRESS: 10024 Whalley Blvd. + 13691 100 Ave., Surrey, BC

SIZE: 0.44 Acres (19,166 Sq.ft.)

PRICE: \$6,750,000

OPPORTUNITY:

- Strategic property - High Rise Development Site.
- Potential for 7.5-9 FAR.
- Assembly may be required, see map on pg.5.
- Ownership map available of the ownership within the block.
- The subject property is only 210 meters away from King George Sky Train Station.
- 30+ active development applications in the immediate area.

AERIAL VIEW



TOPOGRAPHY

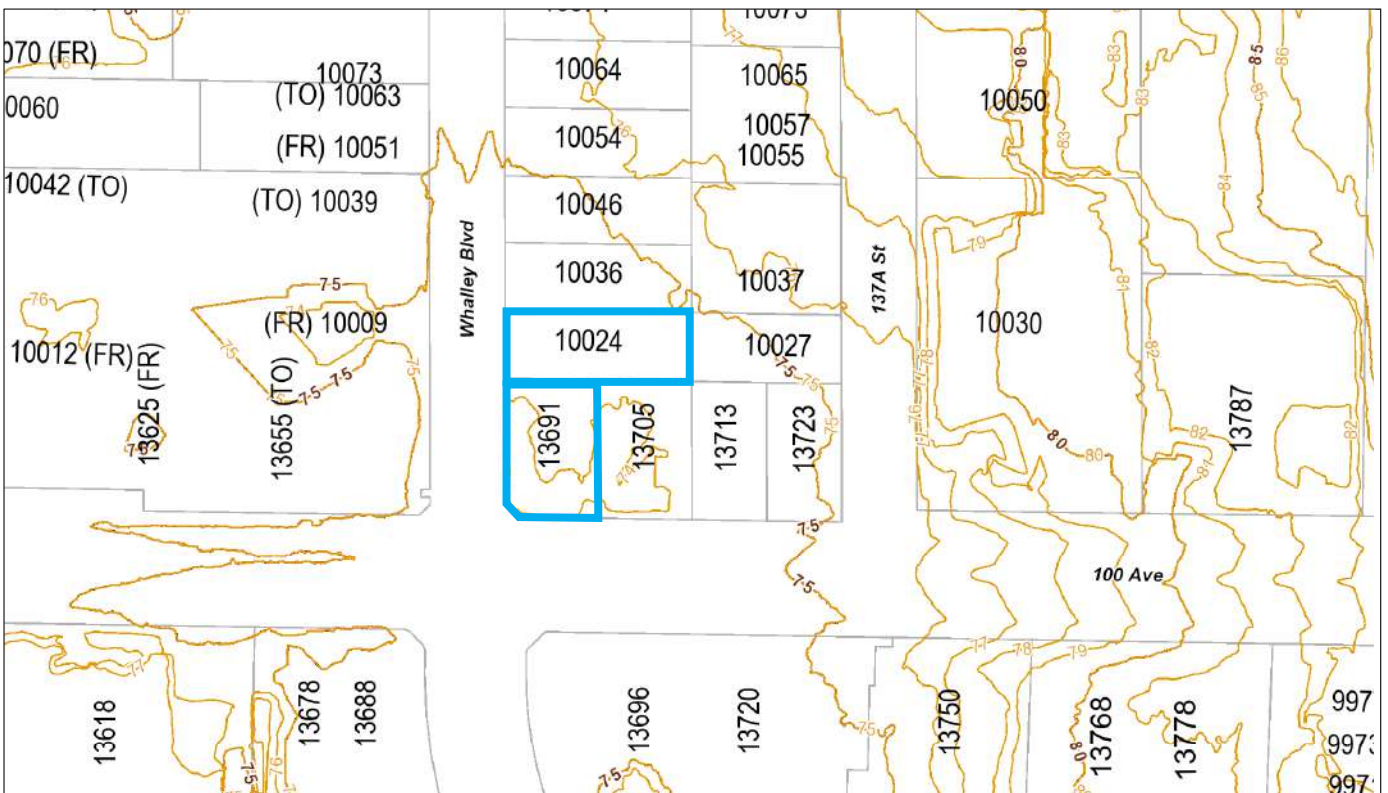

AREA MAP

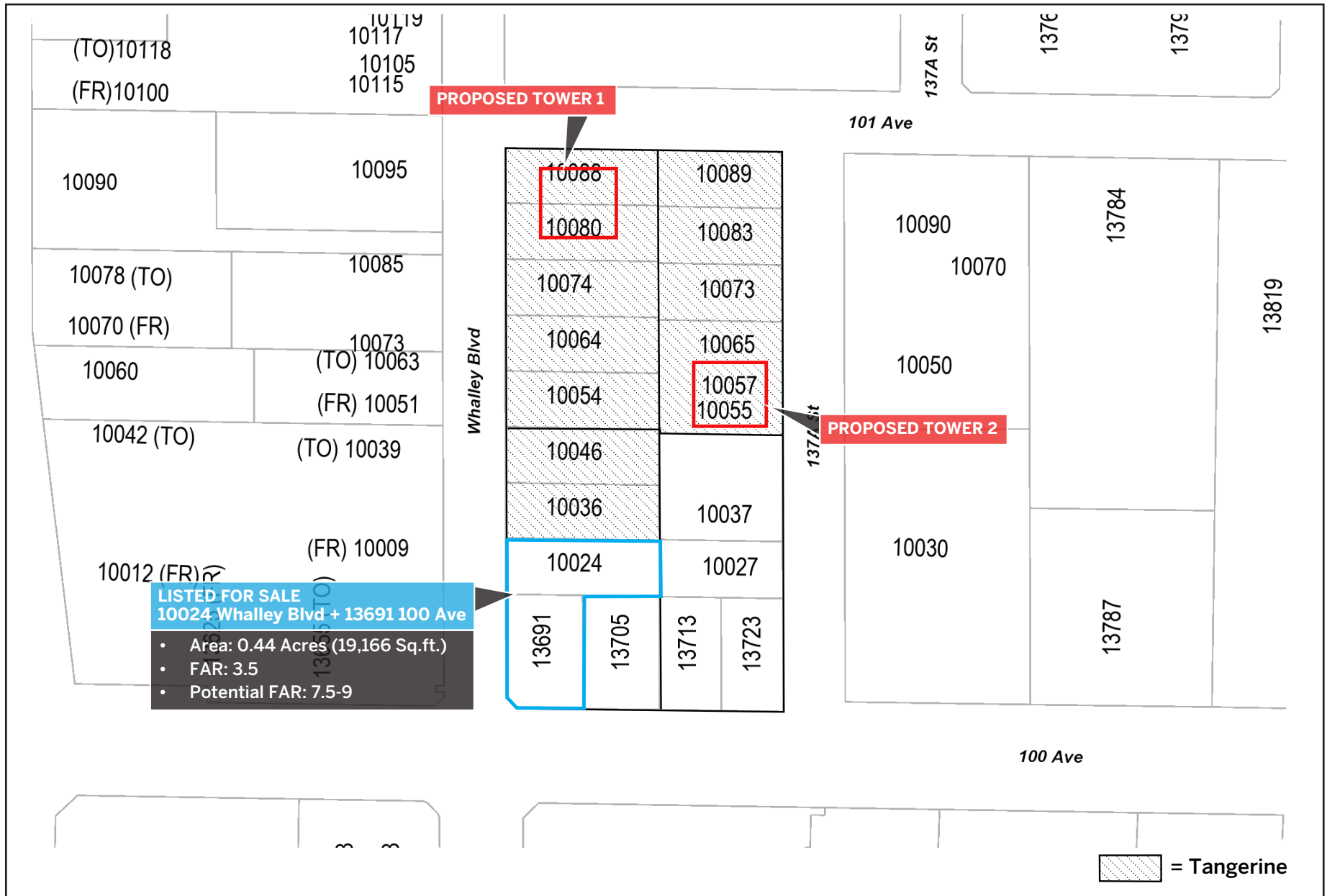

What's your **property** worth?

If you're considering the sale of a property this year, please call/text for an assessment [236.866.6036](tel:236.866.6036) or email at team@varinggroup.com

